

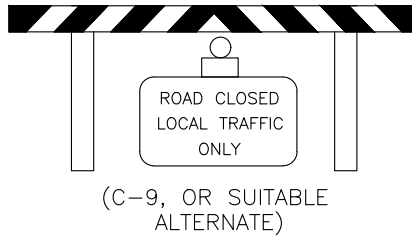

FULL BARRICADE (C-16)



HALF BARRICADE (C-16)

NOTES

1. ALL BARRICADES TO BE REFLECTORIZED UNLESS USED ONLY DURING THE DAYLIGHT HOURS

			CITY OF PRINCE ALBERT		APPROVED
			PUBLIC WORKS		<i>Wes Hicks</i>
			BARRICADES		SCALE N.T.S.
No.	DATE	REVISION	DRAWN S. NUMEDAHL	DESIGNED N. MILLER	DATE OCT. 2014
					DWG. No. 00-00-11